

# PUBLIC WORKS DEPARTMENT

Steve Varela, P.E.  
Director of Public Works/  
City Engineer  
(775) 334-2215

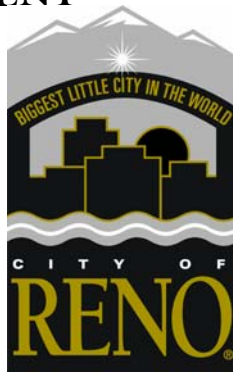

TO: Ted Bendure, FHWA  
Todd Montgomery, NDOT PM  
Steve Varela, P.E., COR  
Gary Robinson, PMC PM  
Ron Dukeshier, Granite PM

CC: Rodger Steen, ASI  
Jim Buntin, BB&A  
Bob Vince, CDM  
Catherine Clark, JBR  
Tom Lennon, WCRM

FR: Mark A. Demuth, EMC PM  
Principal, MADCON Consultation Services

RE: ReTRAC Project – Mitigation Monitoring Program (MMP) **Quarterly Report –4<sup>th</sup> Quarter 2004**

DATE: January 5, 2005

FILE: 19-11.2-0009

---

Attached please find the following summary reports for the 4<sup>th</sup> Quarter 2004 covering the period October, November, and December 2004:

1. ReTRAC Project – Mitigation Monitoring Program (MMP) 4<sup>th</sup> Quarter 2004 Report – Number of Notices/Compliance Reports per Month.
2. ReTRAC Project – Mitigation Monitoring Program (MMP) 4<sup>th</sup> Quarter 2004 Report – Non-Compliance and Notice Details.
3. ReTRAC Project – Mitigation Monitoring Program (MMP) 4<sup>th</sup> Quarter 2004 Report – Non-Compliance and Notice Location Maps.

264 Keystone Ave.  
Reno, Nevada 89503  
Tel. (775) 348-5140  
Fax (775) 348-5180



PO Box 1900  
Reno, Nevada 89505  
www.ReTRAC.org  
SparnichtJ@ci.reno.nv.us

# ReTRAC Project - Mitigation Monitoring Program (MMP) Quarterly Report Fourth Quarter 2004

prepared by the Environmental Management Consultant (EMC) Team

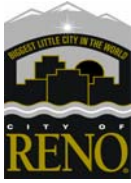

## Number of Notices / Reports per Month

Resource Category	October			November			December			Q4 Totals		
	CR	NCN	NCR	CR	NCN	NCR	CR	NCN	NCR	CR	NCN	NCR
Air Quality	4	-	-	5	-	-	4	-	-	13	-	-
Cultural Resource	37	-	-	43	1	-	33	1	-	113	2	-
General Mitigation Monitoring	-	-	-	-	-	-	-	-	-	-	-	-
Ground Water	-	-	-	-	-	-	-	-	-	-	-	-
Noise and Vibration	3	-	-	5	-	-	6	-	-	14	-	-
Safety and Security	-	-	-	-	-	-	-	-	-	-	-	-
Soils	17	-	-	2	-	-	2	-	-	21	-	-
Surface Water	24	-	-	27	-	-	41	-	-	92	-	-
Transportation and Circulation	-	-	-	-	-	-	-	-	-	-	-	-
<b>Totals</b>	<b>85</b>	<b>-</b>	<b>-</b>	<b>82</b>	<b>1</b>	<b>-</b>	<b>86</b>	<b>1</b>	<b>-</b>	<b>253</b>	<b>2</b>	<b>-</b>

CR = Compliance Report    NCN = Non-Compliance Notice    NCR = Non-Compliance Report

## Mitigation Monitoring Reports Filed During 4th Quarter 2004

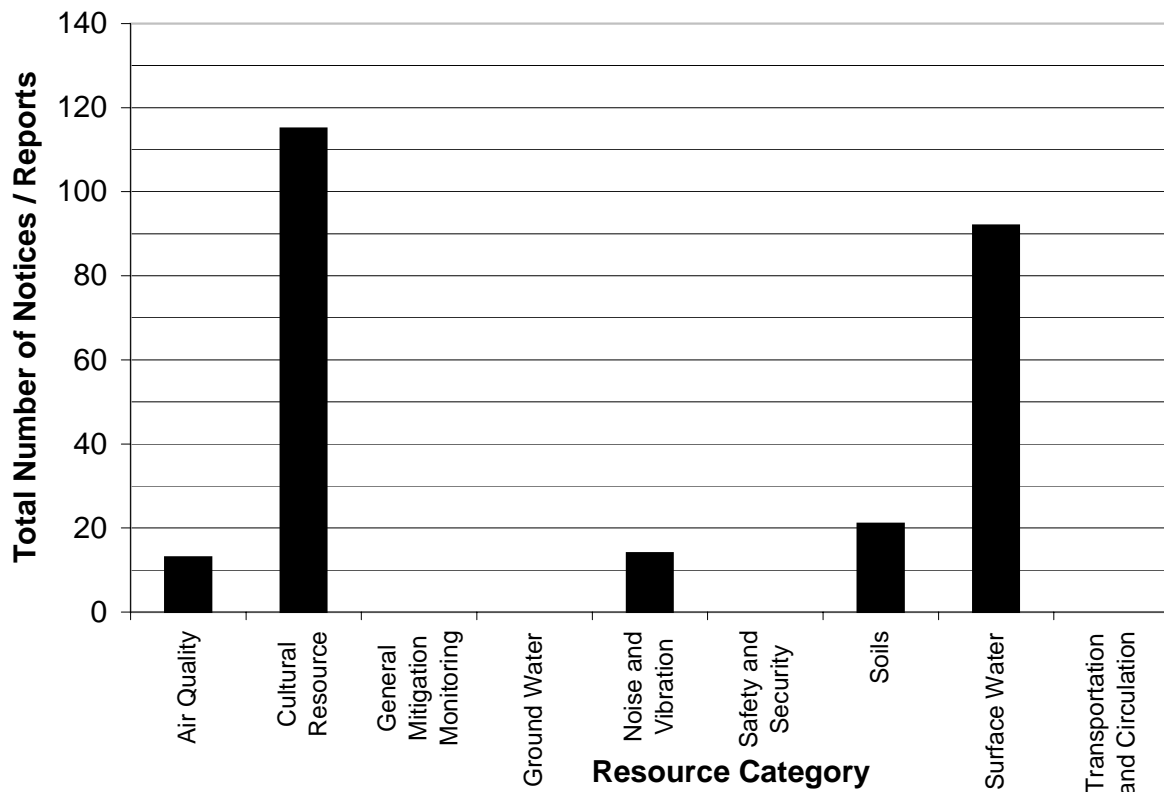

# Q4 2004 Non-Compliance Details

---

**Report ID:** 3952

**Type:** Notice

**Resource:** Cultural Resource

**Observed:** 11/24/2004 1:32:00 PM

**Station:** 2585+00

**Submitted:** 11/24/2004 1:46:10 PM

**Easting:** 257581

**Reported by:** Sigler

**Northing:** 4378836

**Location:** Ralston

**Elevation:** 4500

**Measure(s):** C-40

**Comment:** On 11/23/04 at 3 pm, Chad Hoppe called me and said he needed a monitor for a ramp being excavated on the south side of the main trench corridor between Washington and Ralston. He had already started excavation, and did not call a monitor beforehand as specifically requested by Mark Demuth. Since it would have been nearly 3:30 by the time I could get there, I did not go until first thing the following morning. What had already been excavated was a 34.5 m east-west x 5.5 m north-south portion of the ramp that was entirely in a previously unexcavated area, adjacent to the south side of the already-excavated corridor. Contractor should be aware that the monitor needs to be contacted PRIOR to the beginning of any earth-disturbing activities, so that the monitor has a chance to arrive and actually monitor the activity.-----Follow-up (11-24-2004 by MADCON):On Tuesday 11/23/2004 at 11:30 am, Tony H during dispatched requested a monitor for the following morning (Wednesday) for the above described EDA. Unfortunately work began Tuesday afternoon without a monitor. Foreman Hoppe does understand the necessity of a monitor and though he would call one if anything was found. This matter was discussed with Ron D., Tony Hi., and Chad Hoppe.

---

**Report ID:** 3991

**Type:** Notice

**Resource:** Cultural Resource

**Observed:** 12/9/2004 7:35:00 PM

**Station:** 2611+00

**Submitted:** 12/9/2004 7:40:08 PM

**Easting:** 258418

**Reported by:** Sigler

**Northing:** 4379018

**Location:** Amtrak Depot

**Elevation:** 4500

**Measure(s):** C-40

**Comment:** Yesterday, Granite foreman Rick Bowles began to demo the concrete floor in the western end of the Amtrak/SPRR Depot without an archaeological monitor present even though it was known beforehand that a monitor was required. They excavated a 1 m east-west by 2.1 m north-south portion of the floor down to a depth of 73 cm, exposing a brick wall/foundation segment from an earlier building. The archaeological monitor was not called until this morning.

---

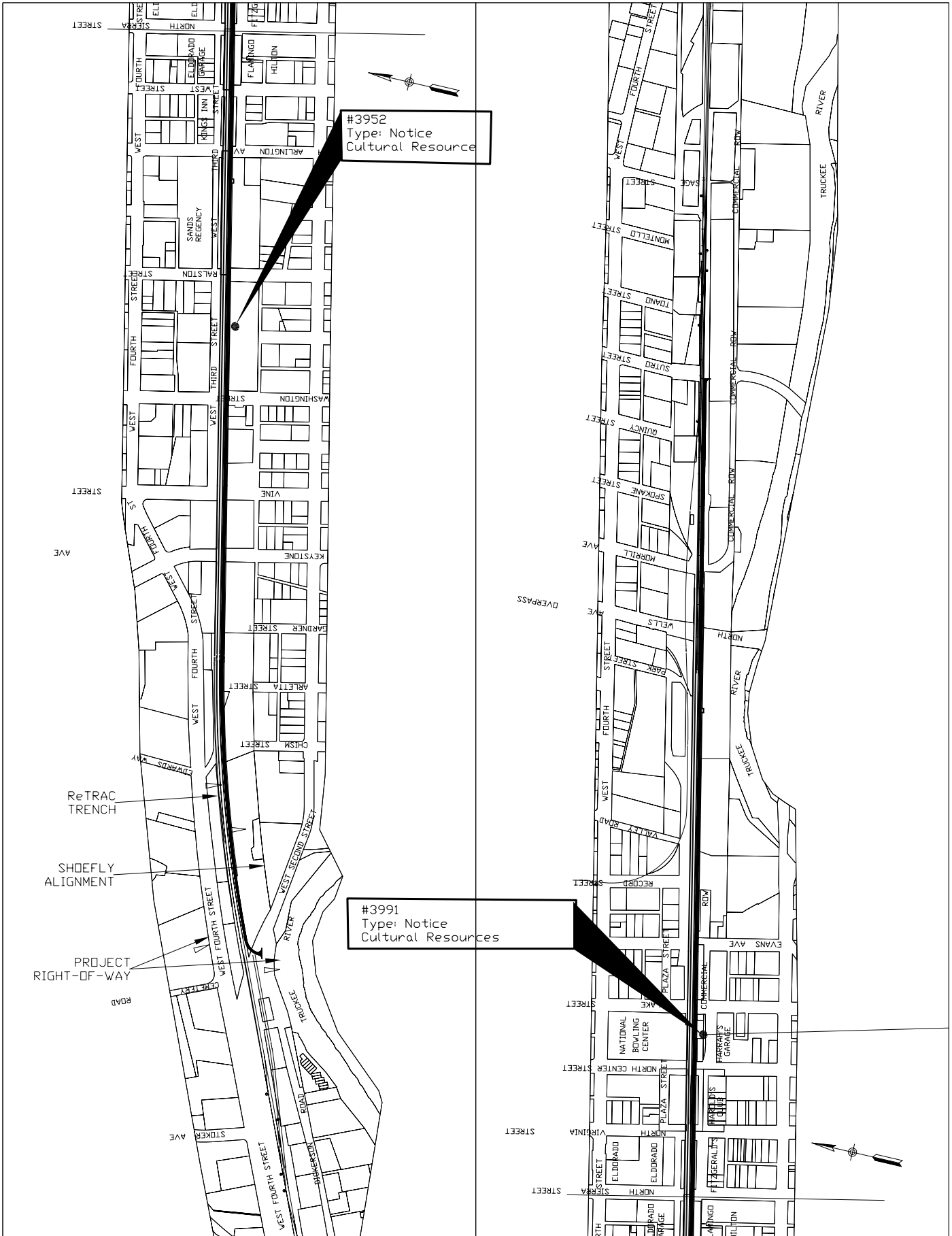

DATE	TIME	LOCATION

RENO ReTRAC

**ReTRAC** THE GRANITE TEAM

SUBM. \_\_\_\_\_  
 APPR. \_\_\_\_\_

Q4 2004  
Non-Compliance  
Details

CONTRACT NO.	
DRAWING NO.	REV
SCALE 1" = 800'	
SHEET NO.	