

PUBLIC WORKS DEPARTMENT

Steve Varela, P.E.
Director of Public Works/
City Engineer
(775) 334-2215

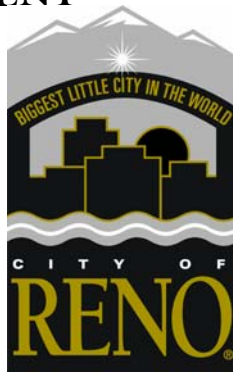

TO: Ted Bendure, FHWA
Todd Montgomery, NDOT PM
Steve Varela, P.E., COR
Gary Robinson, PMC PM
Ron Dukeshier, Granite PM

CC: Rodger Steen, ASI
Jim Buntin, BB&A
Bob Vince, CDM
Catherine Clark, JBR
Tom Lennon, WCRM

FR: Mark A. Demuth, EMC PM
Principal, MADCON Consultation Services

RE: ReTRAC Project – Mitigation Monitoring Program (MMP) **Quarterly Report – 3rd Quarter 2004**

DATE: October 4, 2004

FILE: 19-11.2-0008

Attached please find the following summary reports for the 3rd Quarter 2004 covering the period July, August, and September 2004:

1. ReTRAC Project – Mitigation Monitoring Program (MMP) 3rd Quarter 2004 Report – Number of Notices/Compliance Reports per Month.
2. ReTRAC Project – Mitigation Monitoring Program (MMP) 3rd Quarter 2004 Report – Non-Compliance and Notice Details.
3. ReTRAC Project – Mitigation Monitoring Program (MMP) 3rd Quarter 2004 Report – Non-Compliance and Notice Location Maps.

264 Keystone Ave.
Reno, Nevada 89503
Tel. (775) 348-5140
Fax (775) 348-5180



PO Box 1900
Reno, Nevada 89505
www.ReTRAC.org
SparnichtJ@ci.reno.nv.us

ReTRAC Project - Mitigation Monitoring Program (MMP) Quarterly Report Third Quarter 2004

prepared by the Environmental Management Consultant (EMC) Team

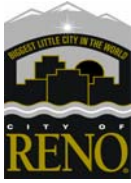

Number of Notices / Reports per Month

Resource Category	July			August			September			Q3 Totals		
	CR	NCN	NCR	CR	NCN	NCR	CR	NCN	NCR	CR	NCN	NCR
Air Quality	2	-	-	4	-	-	19	-	-	25	-	-
Cultural Resource	64	-	-	84	1	-	52	-	-	200	1	-
General Mitigation Monitoring	-	-	-	-	-	-	-	-	-	-	-	-
Ground Water	-	-	-	-	-	-	-	-	-	-	-	-
Noise and Vibration	4	-	-	4	-	-	4	-	-	12	-	-
Safety and Security	-	-	-	-	-	-	-	-	-	-	-	-
Soils	19	-	-	22	-	-	14	-	-	55	-	-
Surface Water	51	1	1	35	-	-	38	-	-	124	1	1
Transportation and Circulation	-	-	-	-	-	-	-	-	-	-	-	-
Totals	140	1	1	149	1	-	127	-	-	416	2	1

CR = Compliance Report NCN = Non-Compliance Notice NCR = Non-Compliance Report

Mitigation Monitoring Reports Filed During 3rd Quarter

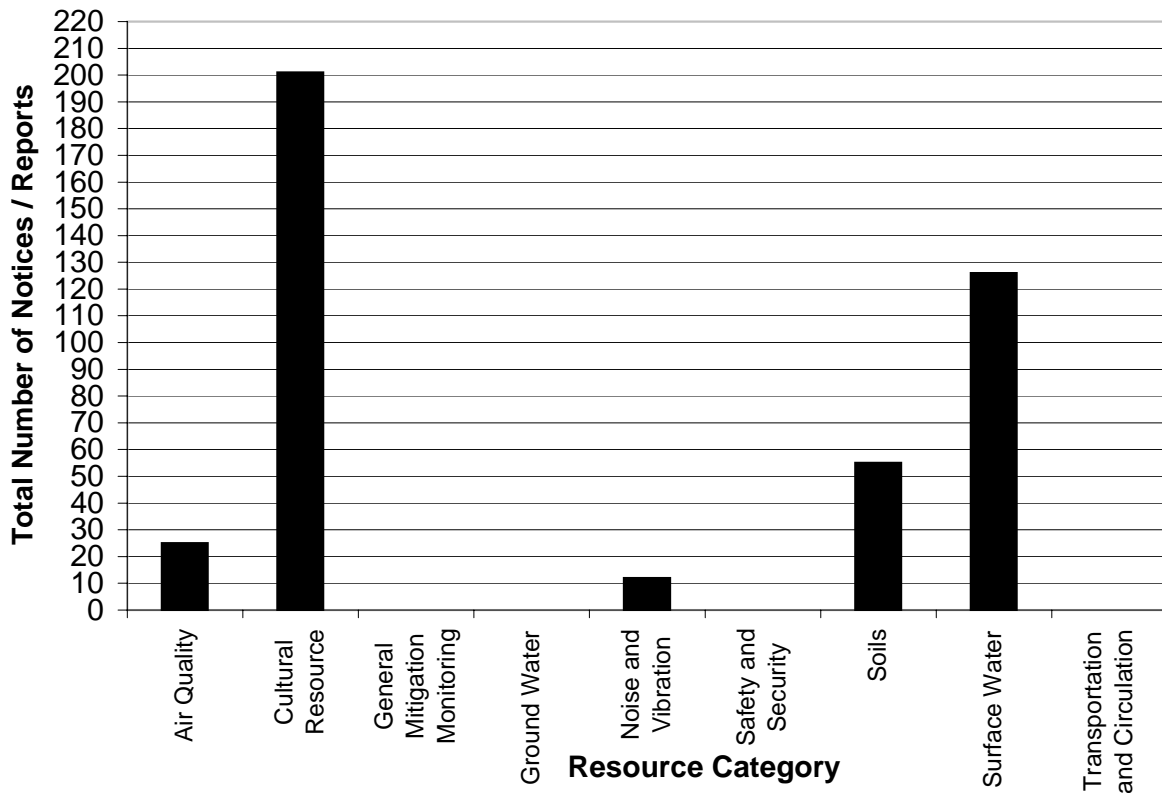

Q3 2004 Non-Compliance Details

Report ID: 3363

Type: Non-compliance

Resource: Surface Water

Observed: 7/13/2004 8:00:00 AM

Station: 2604+00

Submitted: 7/16/2004 9:45:51 AM

Eastings: 258247

Reported by: Demuth

Northing: 4379296

Location: Trench DT

Elevation: 4513

Measure(s): C-3

Comment: EMC conducted a site visit after hearing that Schnabel, at Virginia and Commercial, was discharging ground water to the storm drain system. Upon arrival a trash pump was pumping ponded de-watered groundwater from Schnabel underpinning pits. Schnabel's foreman was instructed to stop all work. He stated he worked for Granite. Granite was called and asked to send someone in charge to stop Schnabel. Don Olbert requested Schnabel stop. According to Schnabel foreman (Bill), they are conducting structure underpinning and have excavation approx. 35' deep, with ground water at approx. 25'. For the past three days they have been pumping out ground water into sediment ponds at the surface. When the ponds filled, they pumped the water to the v-ditch where most of it flowed into an open pipe directly connected to the storm drain system. In the mornings they had to discharge approx. 700 gallons, and throughout the day only a couple gpm. They first encountered ground water 7/9/04. Granite and Schnabel were informed by the EMC that this was in direct conflict with the SWPPP, the General NPDES permit and COR Contract. -----Follow-up (07-13-2004 by MADCON): EMC allowed construction to continue as long as discharge was pre-treated and disposed of per COR permit to Sanitary Sewer. -----Follow-up (07-15-2004 by olbert): On July 13, 2004 at approximately 8am I noticed that Schnabel, one of Granite Construction Company's sub-contractors was working at the Rainbow Bridge, located between 3rd Street and Commercial Row just west of Virginia Street. Schnabel was pumping water from an excavation pit under the Rainbow Bridge to a small pond dug in the ground near the excavation pit. Then Schnabel had an additional pump in the pond pumping the water over a pile of excavated material into a ditch. I observed the water coming out of the pipe in surges and estimated the volume of the water to be 2 to 6 gpm. The ditch is parallel to the Shoofly track north of the Shoofly and south of the excavation area. There is a chain-link fence between the ditch and the Shoofly track. The ditch is in fact a part of the drainage system set up for the Shoofly and aids in draining rainwater away from the train ballast. This ditch drains into a pipe that is directly connected to the Reno storm drain system. I called Mark Demuth of MADCON and reported the incident. I then waited for Mark to arrive on the scene and instructed the Schnabel foreman to cease pumping the water into the ditch. Schnabel stopped pumping into the ditch immediately after I told them to stop. John Collins, Granite's engineer for that operation, was called and informed of the incident. During discussions about the incident the Schnabel foreman estimated that 700 gallons would be pumped out in the mornings and then the water from the excavation would vary from 2 to 6 gpm. John made arrangements for a water tank with weirs to be hauled to the site. This tank will hold the water until a treatment truck can pump the water off and remove it to a site for treatment. An on-the-site meeting was held with Schnabel, Granite, and MADCON personnel to ensure the incident will not be repeated. Don Olbert, PE Quality Assurance Manager

Report ID: 3422

Type: Notice

Resource: Surface Water

Observed: 7/23/2004 9:40:00 AM

Station: 2604+00

Submitted: 7/23/2004 12:47:10 PM

Easting: 258247

Reported by: Demuth

Northing: 4379296

Location: Trench DT

Elevation: 4513

Measure(s): C-3

Comment: Granite's Environmental Quality Assurance Monitor and the EMC's monitor noted water had been discharged into the V-ditch at Virginia Street by A.C.T. (Schnabel subcontractor). Upon Granite's investigation, it was admitted to by A.C.T. Rep. Michael Xu that A.C.T. had discharged approximately 50 - 75 gallons of groundwater in the V-ditch. Although the V-Ditch was muddy and saturated, the pipe leading to the Storm Drain System was dry with no signs of discharge to the system. Action Plan - Granite will hold a meeting this afternoon with Schnabel and A.C.T. and inform them that any discharge to the V-ditch or Storm Drain System in the future will result in the removal of that person from the ReTRAC Project and require on-site daily monitoring by EMC monitors at contractor/subcontractor's expense.

Report ID: 3603

Type: Notice

Resource: Cultural Resource

Observed: 8/25/2004 8:28:00 PM

Station: 2572+00

Submitted: 8/25/2004 9:09:28 PM

Easting: 257656

Reported by: Leavitt

Northing: 4378863

Location: Vine

Elevation: 4501

Measure(s): C-40

Comment: Earlier this month I noted, immediately W of Ralston and in the S bank of the then-completed trench excavation, an intact concrete wall running E/W, with corners indicating additional concrete walls running S into the material of the trench wall. This was identified as potentially associated with Discovery 15. Returning to the site today for further work, I found that the E/W wall was gone, with the stubs of the N/S walls protruding from the trench bank. I later learned that removal of the E/W wall had been approved by Granite's John Collins. Work completed at the site today in my presence was in compliance and involved minimal disturbance to the wall stubs. I left this area at about 7:15 to monitor work further west between Ralston and Vine. Work in that area was in compliance. Returned to the site just west of Ralston late in the day and found that a person, so far unidentified, had used a backhoe to do considerable excavation into the trench bank between the wall stubs without benefit of Cultural Resource Monitoring. The walls themselves were not heavily damaged, although a possible piece of concrete floor had been removed from the base of the eastern wall. A significant portion of the fill material between the walls, and whatever artifacts it may have contained, was gone. Overlying blacktop had been removed, but was not apparent in the immediate area, leading to a presumption that the fill material had been removed from the job site. The site has been flagged with yellow.

N:\ACAD2000\17047\37061\fig\04-2003-NONCOMPLIANCE-DETAILS 01/05/04 14:53 talbotwk XREFS: ReL_site_map_utm27m_revised

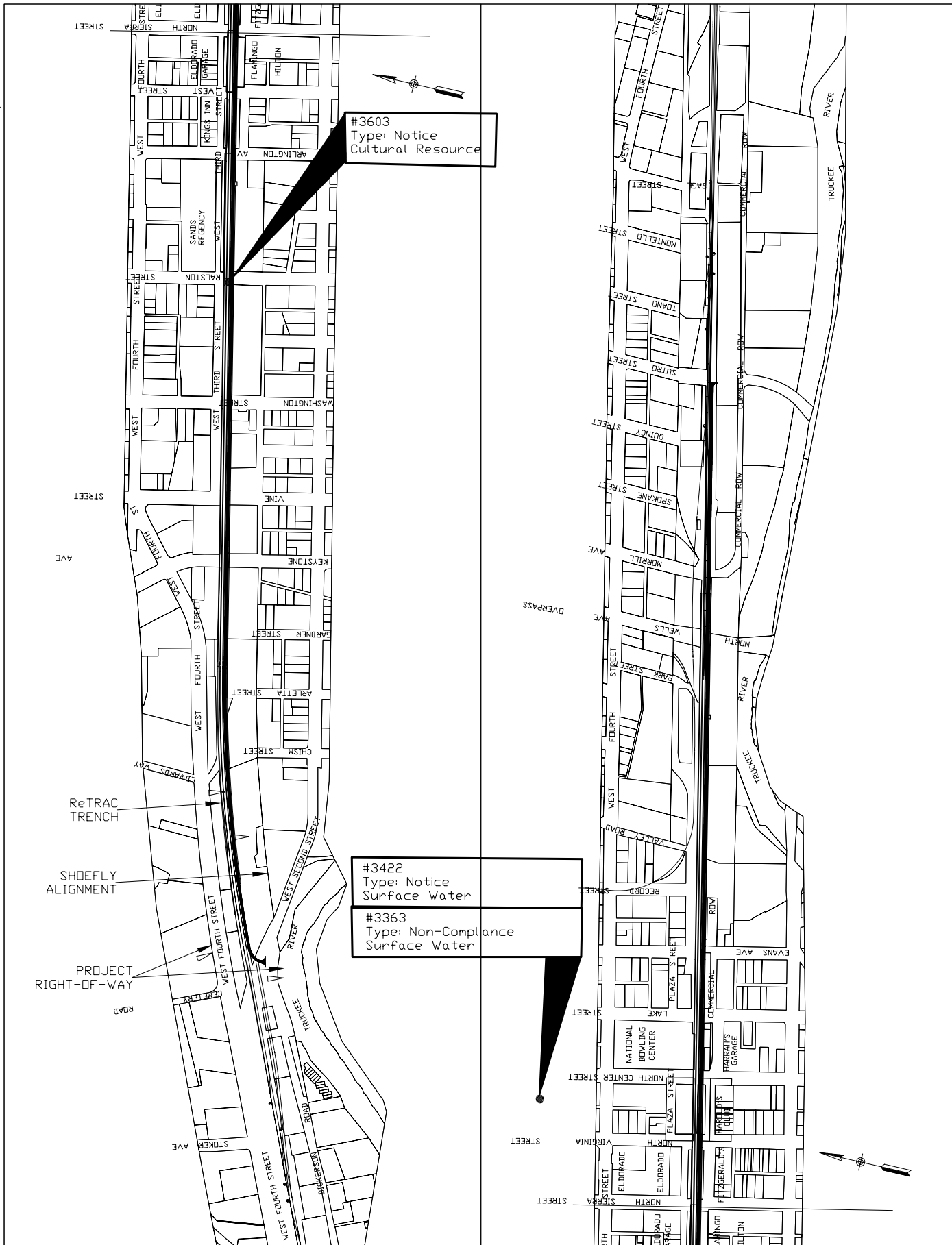

DATE	TIME	LOCATION

RENO ReTRAC

ReTRAC THE GRANITE TEAM

SUBM. _____

APPR. _____

Q3 2004
Non-Compliance
Details

CONTRACT NO.	
DRAWING NO.	REV
SCALE 1" = 800'	
SHEET NO.	