

PUBLIC WORKS DEPARTMENT

Steve Varela, P.E.
Director of Public Works/
City Engineer
(775) 334-2215

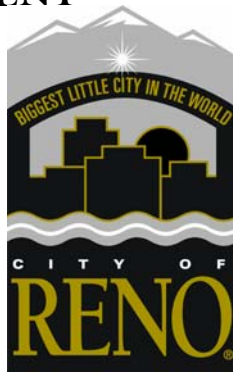

TO: Ted Bendure, FHWA
Todd Montgomery, NDOT PM
Steve Varela, P.E., COR
Gary Robinson, PMC PM
Ron Dukeshier, Granite PM

CC: Rodger Steen, ASI
Jim Buntin, BB&A
Bob Vince, CDM
Catherine Clark, JBR
Tom Lennon, WCRM

FR: Mark A. Demuth, EMC PM
Principal, MADCON Consultation Services

RE: ReTRAC Project – Mitigation Monitoring Program (MMP) **Quarterly Report – 2nd Quarter 2004**

DATE: July 7, 2004

FILE: 19-11.2-0007

Attached please find the following summary reports for the 2nd Quarter 2004 covering the period April, May, and June 2004:

1. ReTRAC Project – Mitigation Monitoring Program (MMP) 2nd Quarter 2004 Report – Number of Notices/Compliance Reports per Month.
2. ReTRAC Project – Mitigation Monitoring Program (MMP) 2nd Quarter 2004 Report – Non-Compliance Details and Location Map.
3. ReTRAC Project – Mitigation Monitoring Program (MMP) 2nd Quarter 2004 Report – Non-Compliance Location Maps.

264 Keystone Ave.
Reno, Nevada 89503
Tel. (775) 348-5140
Fax (775) 348-5180



PO Box 1900
Reno, Nevada 89505
www.ReTRAC.org
SparnichtJ@ci.reno.nv.us

ReTRAC Project - Mitigation Monitoring Program (MMP) Quarterly Report Second Quarter 2004

prepared by the Environmental Management Consultant (EMC) Team

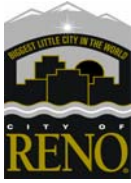

Number of Notices / Reports per Month

Resource Category	April			May			June			Q2 Totals		
	CR	NCN	NCR	CR	NCN	NCR	CR	NCN	NCR	CR	NCN	NCR
Air Quality	5	-	-	3	-	-	3	-	-	11	-	-
Cultural Resource	61	-	-	95	-	-	76	-	-	232	-	-
General Mitigation Monitoring	-	1	-	1	-	-	-	-	-	1	1	-
Ground Water	-	-	-	-	-	-	-	-	-	-	-	-
Noise and Vibration	5	-	-	4	-	-	4	-	-	13	-	-
Safety and Security	-	-	-	-	-	-	-	-	-	-	-	-
Soils	16	-	-	43	1	-	29	-	-	88	1	-
Surface Water	34	-	-	40	-	-	49	-	-	123	-	-
Transportation and Circulation	-	-	-	-	-	-	-	-	-	-	-	-
Totals	121	1	-	186	1	-	161	-	-	468	2	-

CR = Compliance Report NCN = Non-Compliance Notice NCR = Non-Compliance Report

Mitigation Monitoring Reports Filed During 2nd Quarter

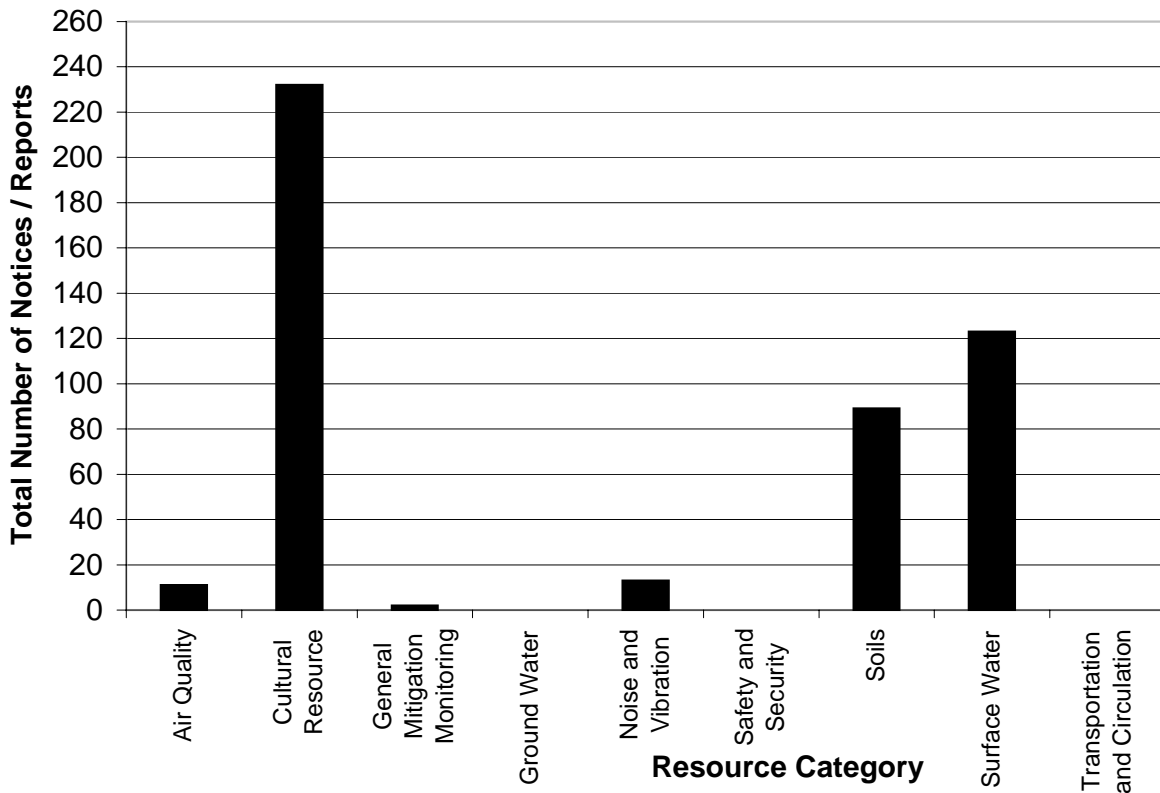

Q2 2004 Non-Compliance Details

Report ID: 2841

Type: Notice

Resource: General Mitigation Monitoring

Observed: 4/16/2004 10:06:00 AM

Station: 2609+00

Submitted: 4/16/2004 10:12:30 AM

Easting: 258349

Reported by: Duncan

Northing: 4379054

Location: Center

Elevation: 4495

Measure(s): "

Comment: Hidden mallard nest inadvertently disturbed when clearing work area. Female mallard returned to nest, which was hidden again with vegetation. Nest area will be protected from pedestrians with chain-link fence on west end. Nest will be protected from construction workers by orange plastic fencing and sign identifying environmentally sensitive area.-----
Follow-up (04-16-2004 by MADCON):In addition to fencing - mallard, nest and eggs are not to be disturbed until ducklings can leave nest under their own power per NDOW and Migratory Bird Treat Act (approx. 25-40 days). If construction to the east is to continue, an 8-foot tall x 8-foot wide wooden barrier (1-inch thick) is to built to protect mallard from further disturbance during construction. Granite is to check on mallard daily to determine effects/success of mitigation.-----
Follow-up (05-10-2004 by MADCON):Mallard on nest hatched 11 ducklings and headed for the Truckee River. MADCON, WCRM, JBR, and Granite personnel escorted family across streets until they all reached the river safely. Construction in nest area can resume now that nest is vacant.

Report ID: 3034

Type: Notice

Resource: Soils

Observed: 5/20/2004 3:30:00 PM

Station: 2625+00

Submitted: 5/20/2004 8:54:40 AM

Easting: 258921

Reported by: Rynders

Northing: 4379148

Location: Trench E

Elevation: 4520

Measure(s): C-1(b)

Comment: On May 19th, 2004, Truck 7/227 of Lyn Marie Trucking Co. failed to dispose of regulated soil due to equipment failure. The truck returned the next a.m. before the dump opened for receiving and disposed his soil without supervision of the waste management staff and did not receive a scale ticket or signed manifest to verify that the soil reached its required final destination. These are specifically forbidden actions, and warrant a notice.

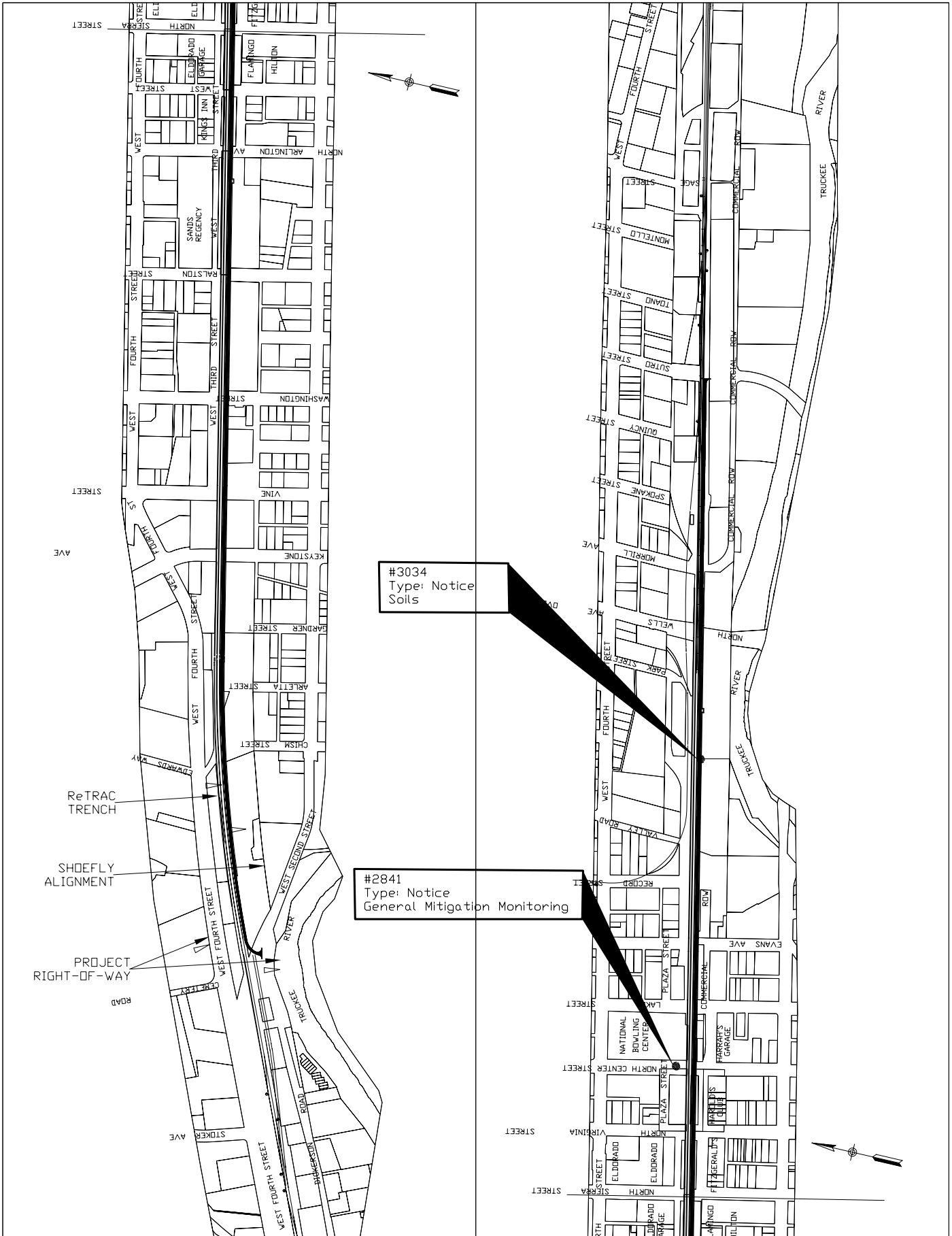

DATE	TIME	LOCATION

RENO ReTRAC

ReTRAC THE GRANITE TEAM

SUBM. _____
 APPR. _____

Q2 2004
Non-Compliance
Details

CONTRACT NO.	
DRAWING NO.	REV
SCALE 1" = 800'	
SHEET NO.	