

PUBLIC WORKS DEPARTMENT

Steve Varela, P.E.
*Director of Public Works/
City Engineer*
(775) 334-2215



John Sparnicht, P.E.
Project Manager
(775) 334-1286

TO: Ted Bendure, FHWA
Todd Montgomery, NDOT PM
John Sparnicht, COR PM
Gary Robinson, PMC PM
Jim Laing, Granite PM

CC: Steve Varela, P.E., COR
Don Olbert, Granite QAM
Rodger Steen, ASI
Jim Buntin, BB&A
Bob Vince, CDM
Catherine Clark, JBR
Tom Lennon, WCRM

FR:  Mark A. Demuth, EMC PM
Principal, MADCON Consultation Services

RE: ReTRAC Project – Mitigation Monitoring Program (MMP) **Quarterly Report – 4th Quarter 2002**

DATE: January 27, 2003

FILE: 19-11.2-0001

Attached please find the following summary reports for the 4th Quarter 2002 covering the period October, November, and December of 2002:

1. ReTRAC Project – Mitigation Monitoring Program (MMP) 4th Quarter 2002 Report – Number of Notices/Compliance Reports per Month.
2. ReTRAC Project – Mitigation Monitoring Program (MMP) 4th Quarter 2002 Report – Non-Compliance Details and Location Map.
3. ReTRAC Project – Mitigation Monitoring Program (MMP) 4th Quarter 2002 Report – Non-Compliance Location Map.

264 Keystone Ave.
Reno, Nevada 89503
Tel. (775) 348-5140
Fax (775) 348-5180



PO Box 1900
Reno, Nevada 89505
www.ReTRAC.org
SparnichtJ@ci.reno.nv.us

ReTRAC Project - Mitigation Monitoring Program (MMP) Quarterly Report Fourth Quarter 2002

prepared by the Environmental Management Consultant (EMC) Team

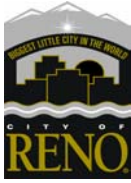

Number of Notices / Reports per Month

Resource Category	October			November			December			Q4 Totals		
	CR	NCN	NCR	CR	NCN	NCR	CR	NCN	NCR	CR	NCN	NCR
Air Quality	1	-	-	-	-	-	-	-	-	1	-	-
Cultural Resource	30	1	-	21	-	-	13	1	-	64	2	-
General Mitigation Monitoring	19	-	-	-	-	-	-	-	-	19	-	-
Ground Water	-	-	-	-	-	-	-	-	-	-	-	-
Noise and Vibration	2	-	-	-	-	-	-	-	-	2	-	-
Safety and Security	-	-	-	-	-	-	-	-	-	-	-	-
Soils	-	-	-	10	-	-	9	-	-	19	-	-
Surface Water	-	-	-	2	-	-	-	-	-	2	-	-
Transportation and Circulation	-	-	-	-	-	-	-	-	-	-	-	-
Totals	52	1	-	33	-	-	22	1	-	107	2	-

CR = Compliance Report NCN = Non-Compliance Notice NCR = Non-Compliance Report

Mitigation Monitoring Reports Filed During 4th Quarter 2002

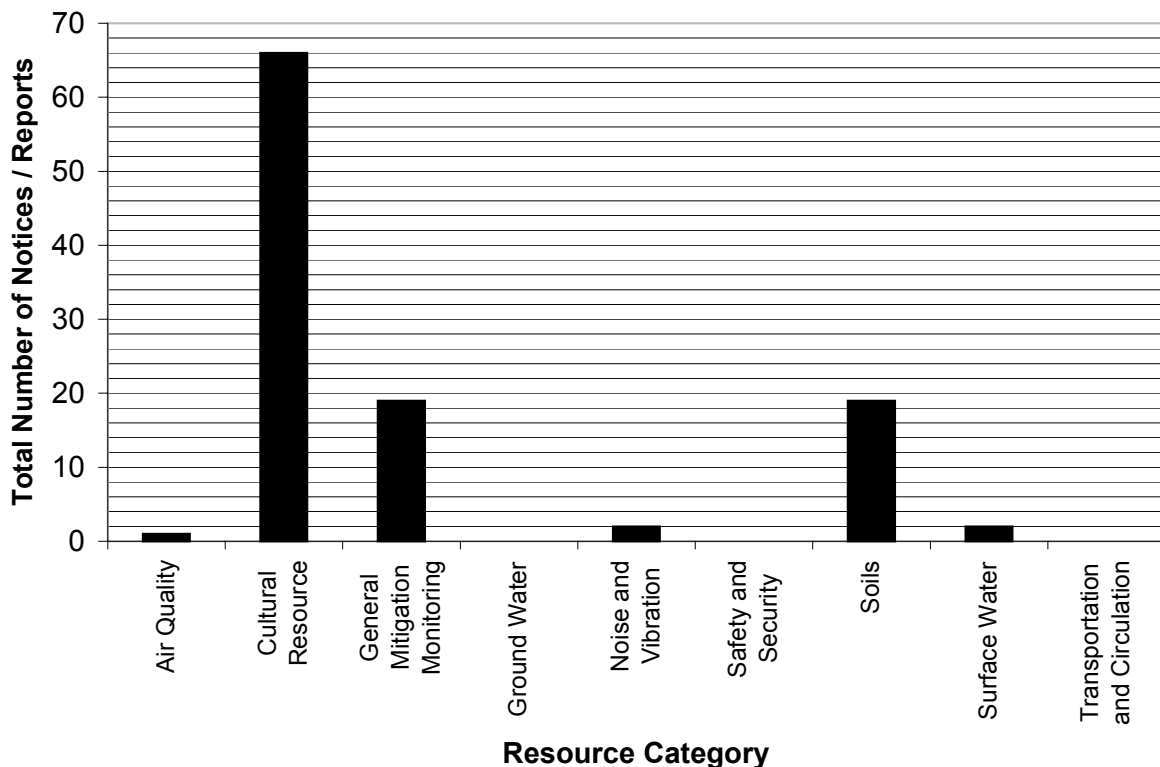

Q4 2002 Non-Compliance Details

Report ID: 81

Type: Notice

Resource: Cultural Resource

Observed: 10/29/2002 10:30:00 AM

Station: 2569+00

Submitted: 10/31/2002 3:10:24 PM

Easting: 257176

Reported by: Demuth

Northing: 4378727

Location: Keystone

Elevation: 4550

Measure(s): C-40

Comment: Discovery of potentially significant CR - work stopped by EMC - FHWA & City notified. Follow-up (10-30-2002 by madcon): 10-30-02, 10:30a: EMC recd verbal approval from the SHPO to re-start work. See letter dated October 30, 2002 from Alice Baldrice, SHPO.

Report ID: 128

Type: Notice

Resource: Cultural Resource

Observed: 12/11/2002 9:10:00 AM

Station: 2568+00

Submitted: 12/12/2002 11:24:15 AM

Easting: 257135

Reported by: Demuth

Northing: 4378816

Location: Keystone

Elevation: 4469

Measure(s): C-40

Comment: EDA were completed by Nevada Bell for Keystone line pole installation. EMC was not notified of EDA and therefore monitoring for CR was not possible. GCCo is notified that all EDAs require CR monitoring. EDA was contained entirely within fill material under existing sidewalk. Follow-up (12-12-2002 by olbert): Nevada Bell began work on short notice to GCCo. Nevada Bell was advised to give GCCo adequate advance notice so that EMC can be given adequate notice to schedule CR monitoring.

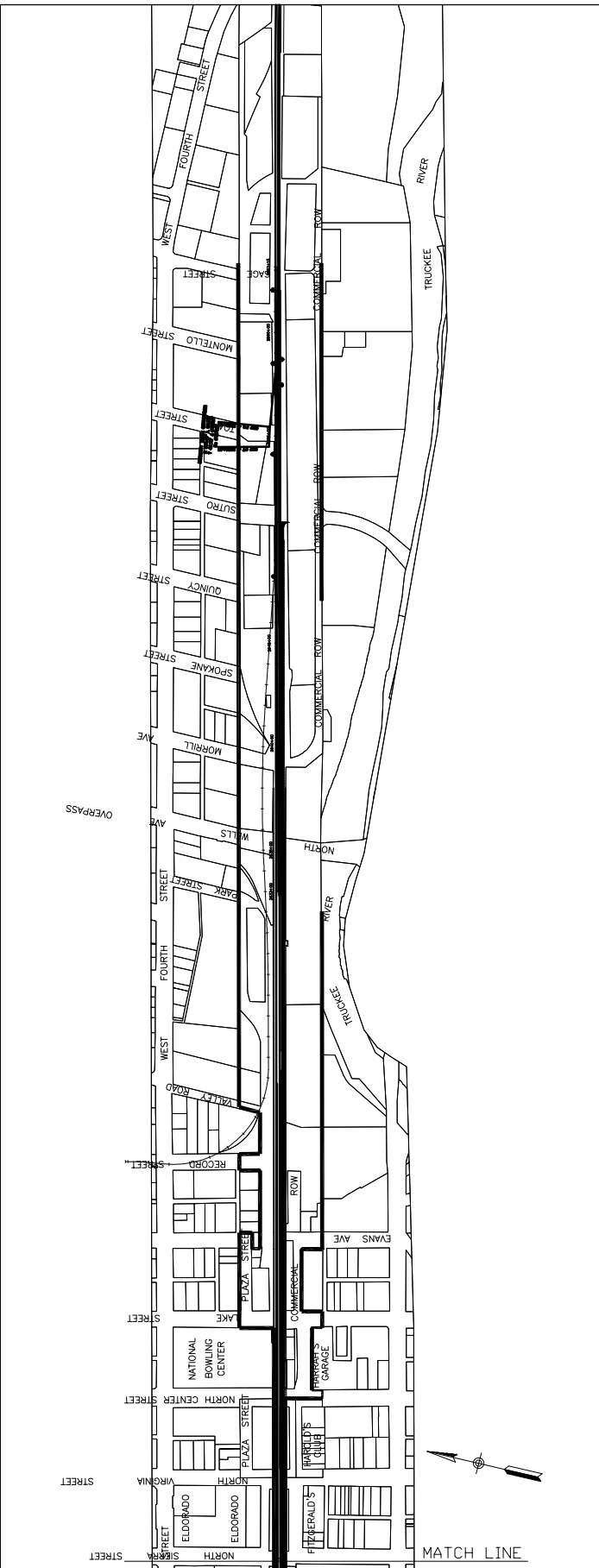
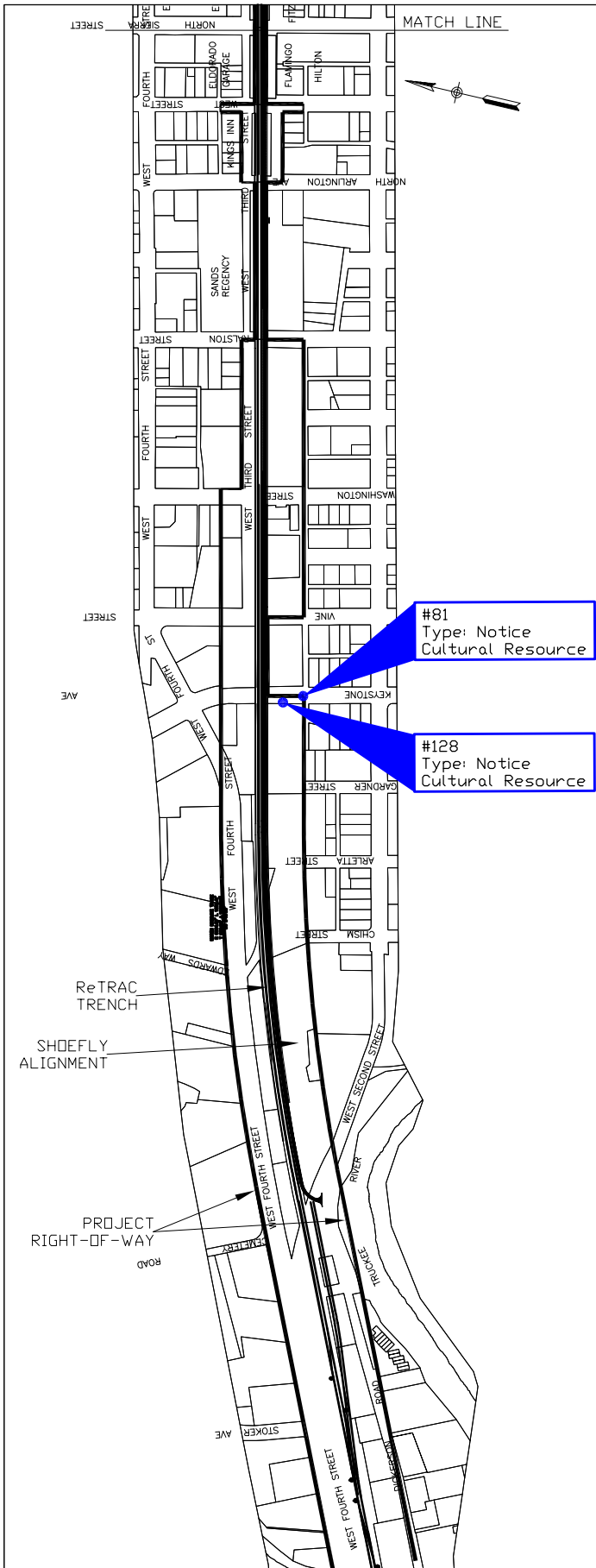

DATE	TIME	LOCATION

RENO ReTRAC

SUBM. _____
 APPR. _____

Q4 2002
 Non-Compliance
 Location Map

CONTRACT NO.	
DRAWING NO.	REV
SCALE 1" = 800'	
SHEET NO.	